

INSTRUCTION FOR ACTIVATING AND MIXING

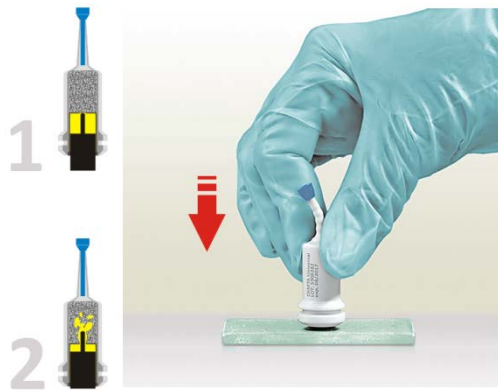

For activation of the DirectCup press the plunger on a hard and plane surface to the end into the DirectCup



Insert the DirectCup into the applicator and click **once** to standardize.

Note: The plunger must be at the same level as the bottom of the capsule.

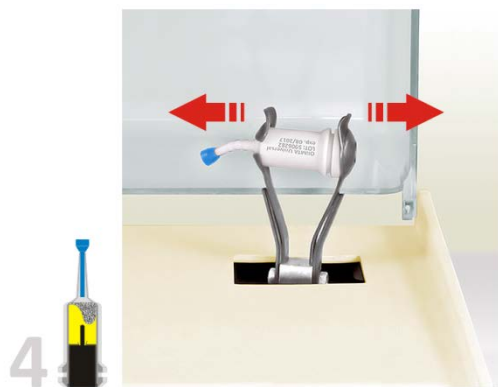

Insert the DirectCup into a mixer (or an amalgamator), close lid and mix immediately for 30 seconds (about 4300 oscillations / min).

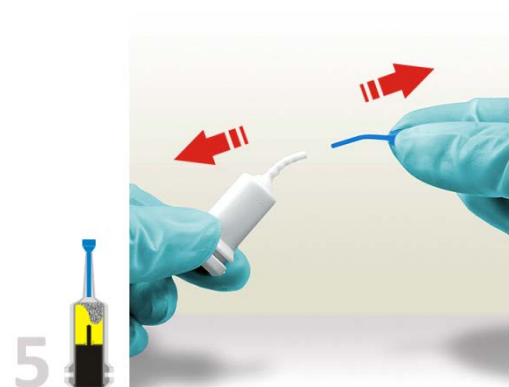

Remove the pin from the nozzle. If not, capsule can burst.

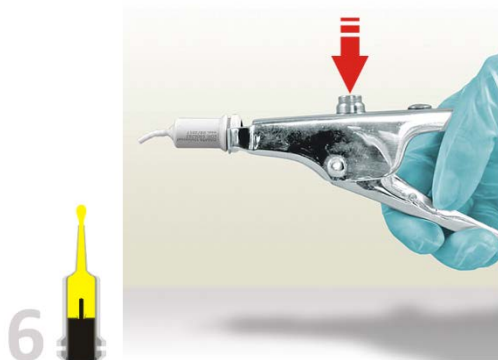

Insert the DirectCup into the applicator. Pull the lever 2 times (2 clicks) to prime the DirectCup. Extrude the mixed material on a glass plate and apply directly. Unlock the gun (push button A) and remove the DirectCup.

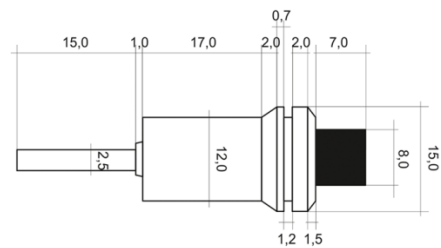

PACKAGING AND THE REFERENCE NUMBER

2x OliIMTA Universal Direct Cup 0,30 g, this instruction of use | OL007

Version 02/2019

 OLIDENT Sp. z o. o., Sp. k.  
32-003 Podtęże  
Podtęże 653  
tel.: +48/12/650 70 10  
info@olident.com  
www.olident.com  
www.olidentdentalshop.pl



© OLIDENT® 2019

Made in EU

